

King William Street

SOUTHVILLE

APPROXIMATE FLOOR AREA
82.2 SQM / 885 SQFT



GARDEN ROOM
0 sq.ft. (0.0 sq.m.) approx.

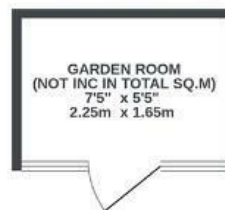

GROUND FLOOR
521 sq.ft. (48.4 sq.m.) approx.

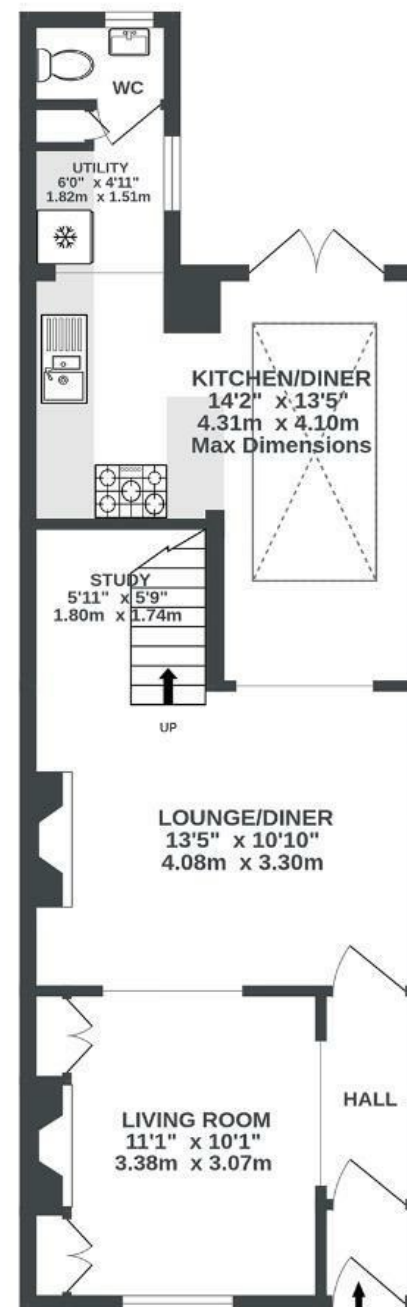

1ST FLOOR
364 sq.ft. (33.6 sq.m.) approx.



Illustrations are for reference purposes only, measurements are approximate, not to scale.

Boardwalk

King William

, BRISTOL



£465,000



2 Bedrooms



BS3 1HH



2 Bathrooms

"Southville is a vibrant area while still feeling friendly and peaceful. We've loved the independent cafés, bakeries, local shops and nearby green spaces, as well as being able to walk into the city centre in around 25 minutes. It's also easy to get anywhere by bus (there's even a direct one to the airport, which has been a lifesaver). It's been a brilliant place to raise a family with excellent schools close by. It's a neighbourhood that's easy to settle into and hard to leave."

